

Archaeological Evaluation on Land at Newnham Park, Bearsted Road, Maidstone, Kent

Site Code: BEAR -EV-18

NGR Site Centre 578114 157287

Planning Application Number: 18/5034459/FULL



SWAT ARCHAEOLOGY

Swale and Thames Archaeological Survey Company

The Office, School Farm Oast, Graveney Road

Faversham, Kent ME13 8UP

Tel; 01795 532548 or 07885 700 112

info@swatarchaeology.co.uk www.swatarchaeology.co.uk

© SWAT Archaeology 2018 all rights reserved

Contents

1	INTRODUCTION	5
1.1	Project Background	5
1.2	Site Description and Topography	5
2	ARCHAEOLOGICAL AND HISTORICAL BACKGROUND.....	5
2.1	Introduction	5
3	AIMS AND OBJECTIVES.....	6
3.1	Specific Aims (SWAT 2018)	6
3.2	General Aims	6
4	METHODOLOGY.....	6
4.1	Introduction	6
4.2	Fieldwork.....	7
4.3	Recording	7
5	RESULTS	7
5.1	Introduction	7
5.2	Stratigraphic Deposit Sequence	8
5.3	Overview	8
6	FINDS	8
6.1	Introduction	8
7	DISCUSSION.....	8
7.1	Archaeological Narrative.....	8
7.2	Conclusions	8
8	ARCHIVE.....	8
8.1	General.....	8

9 **ACKNOWLEDGMENTS** 9

10 **REFERENCES** 9

11 **APPENDIX 1 – TRENCH TABLES** 10

Figures

- Figure 1 Site location map
- Figure 2 Trench location
- Figure 3 Plan Trenches 1 -10

- Plates 1- 14 Trenches and sections

Summary

Swale & Thames Survey Company (SWAT Archaeology) was commissioned to undertake an archaeological evaluation on land at Newnham Park, Bearsted Road, Maidstone in Kent. The archaeological works were monitored by the Kent County Council Senior Archaeological Officer.

The fieldwork was carried out in October 2018 in accordance with an archaeological specification (SWAT Archaeology 2018) submitted to the Local Planning Authority prior to commencement of works.

The Archaeological Evaluation consisted of 10 trenches, which encountered a relatively common stratigraphic sequence comprising topsoil and subsoil overlying natural geology.

1 INTRODUCTION

1.1 Project Background

1.1.1 Swale & Thames Survey Company (SWAT Archaeology) was commissioned to undertake an archaeological evaluation on land at Newnham Park, Bearsted in Kent (**Figure 1**). The land has planning permission (18/5034459/FULL) for the build of car parking and landscaping.

1.1.2 In mitigation of the potential impact that the development may have on the buried archaeological resource Kent County Council Heritage & Conservation (KKCHC), who provide an advisory service to Maidstone Borough Council (MBC), requested that the programme of archaeological works comprising an archaeological evaluation

1.1.3 The archaeological evaluation was carried out in October 2018 in accordance with an archaeological specification prepared by SWAT Archaeology (2018), prior to commencement of works, and in discussion with Wendy Rogers Senior Archaeological Officer at KCCHC.

1.1.4 Site Description and Topography

The site is situated just south of the M20 motorway and to the east of the A249.

The town of Maidstone is situated to the south west of the site and to the east Bearsted Golf Course and Club. Eclipse Park is adjacent to the west and Newnham Veterinary Hospital immediately to the south. The NGR to the centre of the site is NGR 578114 157287 (Figure 1).

The Geological Survey of Great Britain (1:50,000) shows that the PDA is set on Bedrock Geology of Bedrock geology of Folkestone Formation- Sandstone. Superficial deposits are not recorded but revealed on site as sand. The PDA is set at an average height of 70.00m AOD.

2 ARCHAEOLOGICAL AND HISTORICAL BACKGROUND

2.1 Introduction

2.1.1 Further details of previous discoveries and investigations within the immediate and wider area may be found in the Kent County Council Historic Environment Record and have been summarised in the Specification produced by SWAT Archaeology (2018).

3 AIMS AND OBJECTIVES

3.1 Specific Aims (SWAT 2018)

3.1.1 The specific aims of the archaeological fieldwork are set out in the Specification (SWAT 2018) were to:

3.1.2 *'The primary objective of the archaeological evaluation is to establish or otherwise the presence of any potential archaeological features which may be impacted by the proposed development. The aims of this investigation are to determine the potential for archaeological activity and in particular the adjacent Roman remains and later archaeological activity.'*

3.1.3 *The programme of archaeological work should be carried out in a phased approach and will commence with a geophysical survey and evaluation through trial trenching. This initial phase should determine whether any significant archaeological remains would be affected by the development and if so what mitigation measures are appropriate. Such measures may include further detailed archaeological excavation, or an archaeological watching brief during construction work or an engineering solution to any preservation in situ requirements'.*

(SWAT Archaeology 2018: 6)

3.2 General Aims

3.2.1 The general aims of the archaeological fieldwork were to;

- establish the presence or absence of any elements of the archaeological resource, both artefacts and ecofacts of archaeological interest across the area of the development;
- ascertain the extent, depth below ground surface, depth of deposit if possible, character, date and quality of any such archaeological remains by limited sample excavation;
- determine the state of preservation and importance of the archaeological resource, if present, and to assess the past impacts on the site and pay particular attention to the character, height/depth below ground level, condition, date and significance of any archaeological deposits.

4 METHODOLOGY

4.1 Introduction

4.1.1 All fieldwork was conducted in accordance with the methodology set out in the Specification (SWAT 2018 and KCC Manual of Specifications 'B') and carried out in compliance with the standards outlined in the Chartered Institute for Archaeologists' Standards Guidance for Archaeological Evaluations (Cifa 2017).

4.2 Fieldwork

4.2.1 A total of ten evaluation trenches were excavated across the Site (Figures 2, 3).

4.2.2 Each trench was initially scanned for surface finds prior to excavation. Excavation was carried out using a 360° mechanical excavator fitted with a toothless ditching bucket, removing the overburden to the top of the first recognisable archaeological horizon, under the constant supervision of an experienced archaeologist.

4.2.3 Where appropriate, trenches, or specific areas of trenches, were subsequently hand-cleaned to reveal features in plan and carefully selected cross-sections through the features were excavated to enable sufficient information about form, development date and stratigraphic relationships to be recorded without prejudice to more extensive investigations, should these prove to be necessary. All archaeological work was carried out in accordance with KCC and ClfA standards and guidance. A complete photographic record was maintained on site that included working shots; during mechanical excavation, following archaeological investigations and during back filling.

4.3 Recording

4.3.1 A complete drawn record of the evaluation trenches comprising both plans and sections, drawn to appropriate scales (1:20 for plans, 1:10 for sections) was undertaken. The plans and sections were annotated with coordinates and aOD heights. These are retained in the site project archive.

4.3.2 Photographs were taken as appropriate providing a record of excavated features and deposits, along with images of the overall trench to illustrate their location and context. The record also includes images of the Site overall. The photographic record comprises digital photography. A photographic register of all photographs taken is contained within the site project archive.

4.3.3 A single context recording system was used to record the deposits. A full list is presented in Appendix 1. Layers and fills are identified in this report thus (100), whilst the cut of the feature is shown [100]. Context numbers were assigned to all deposits for recording purposes. Each number has been attributed to a specific trench with the primary number(s) relating to specific trenches (*i.e.* Trench 1, 101+, Trench 2, 201+, Trench 3, 301+ etc.).

5 RESULTS

5.1 Introduction

5.1.1 A total of ten evaluation trenches were mechanically excavated under archaeological supervision.

5.2 Stratigraphic Deposit Sequence

5.2.1 A relatively consistent stratigraphic sequence was recorded across the majority of the Site comprising a mix of topsoil sealing an intact subsoil of yellow orange sandy clayey silt overlaying the natural sand.

5.2.2 Appendix 1 provides the stratigraphic sequence for all trenches. Figures 1-3 provide a site plan and trench location plan while Plates 1-14 include selected site photographs.

5.3 Overview

5.3.1 The ten trenches were located across the site to ensure full coverage of potential archaeological remains.

6 FINDS

6.1 No finds of any archaeological merit were recovered from the archaeological evaluation

7 Discussion

7.1 Archaeological Narrative

7.1.1 No archaeological features were recorded in any of the trenches.

7.2 Conclusions

7.2.1 The archaeological evaluation has been successful in fulfilling the primary aims and objectives of the Specification. Development proposals are not likely to impact on archaeological remains.

7.2.2 This evaluation has, therefore, assessed the archaeological potential of land intended for development. The results from this work show that the proposed development is not likely to impact on any archaeological remains.

8 ARCHIVE

8.1 General

8.1.1 The Site archive, which will include; paper records, photographic records, graphics and digital data, will be prepared following nationally recommended guidelines (SMA 1995; ClfA 2009; Brown 2011; ADS 2013).

8.1.2 All archive elements will be marked with the site/accession code, and a full index will be prepared. The physical archive comprises 1 file/document case of paper records & A4 graphics

9 ACKNOWLEDGMENTS

9.1.1 SWAT would like to thank the developer for commissioning the project. Thanks are also extended to Wendy Rogers, Senior Archaeological Officer, Kent County Council, for her advice and assistance.

9.1.2 Paul Wilkinson MCIfA supervised the archaeological evaluation and illustrations were produced by Bartek Cichy. Paul Wilkinson MCIfA produced the text for this report.

10 REFERENCES

ADS 2013. Caring for Digital Data in Archaeology: a guide to good practice, Archaeology Data Service & Digital Antiquity Guides to Good Practice

Brown, D.H., 2011. Archaeological archives; a guide to best practice in creation, compilation, transfer and curation, Archaeological Archives Forum (revised edition)

Chartered Institute for Archaeologists, 2009, Standard and Guidance for the creation, compilation, transfer and deposition of archaeological archives, Institute for Archaeologists

Chartered Institute for Archaeologists, 2014, *Standard and guidance: for field evaluation*.

Chartered Institute for Archaeologists, 2014, *Standard and guidance for the creation, compilation, transfer and deposition of archaeological archives*.

Compiled by: SWAT Archaeology (PW). The Office, School Farm Oast, Faversham, Kent

Date: 15/10/2018

Appendix 1: Trench Tables

Trench 1	Dimensions: 27.5m x 1.6m Depth: 0.70m Trench alignment: NNW-SSE NNW-end Ground Level: 72.60m aOD, SSE-end Ground Level: 72.65m aOD		
Context	Description	Interpretation	Depth (m)
101	Topsoil	Topsoil layer	0.00-0.15
102	Mid orange brown, clayey sandy silt	Subsoil	0.15-45
103	Yellow brown sand	Natural	0.45-

Trench 2	Dimensions: 16m x 1.6m Depth: 0.60m Trench alignment: NNW-SSE NNW-end Ground Level: 72.50m aOD, SSE-end Ground Level: 72.60m aOD		
Context	Description	Interpretation	Depth (m)
201	Topsoil	Topsoil layer	0.00-0.15
202	Mid orange brown, clayey sandy silt	Subsoil	0.15-40
203	Yellow brown sand	Natural	0.40-

Trench 3	Dimensions: 20m x 1.6m Depth: 0.70m Trench alignment: NNW-SSE NNW-end Ground Level: 72.55m aOD, SSE-end Ground Level: 72.65m aOD		
Context	Description	Interpretation	Depth (m)
301	Topsoil	Topsoil layer	0.00-0.15
302	Mid orange brown, clayey sandy silt	Subsoil	0.15-45
303	Yellow brown sand	Natural	0.45-

Trench 4	Dimensions: 25m x 1.6m Depth: 0.70m Trench alignment: NNE-WSW NNE-end Ground Level: 72.60m aOD, WSW-end Ground Level: 72.65m aOD		
Context	Description	Interpretation	Depth (m)
401	Topsoil	Topsoil layer	0.00-0.15
402	Mid orange brown, clayey sandy silt	Subsoil	0.15-45
403	Yellow brown sand	Natural	0.45-

Trench 5	Dimensions: 25m x 1.6m Depth: 0.70m Trench alignment: NNE-WSW NNE-end Ground Level: 72.60m aOD, WSW-end Ground Level: 72.65m aOD		
Context	Description	Interpretation	Depth (m)
501	Topsoil	Topsoil layer	0.00-0.15
502	Mid orange brown, clayey sandy silt	Subsoil	0.15-40
503	Yellow brown sand	Natural	0.40-

Trench 6	Dimensions: 25m x 1.6m Depth: 0.65m Trench alignment: NNW-SSE NNW-end Ground Level: 72.55m aOD, SSE-end Ground Level: 72.65m aOD		
Context	Description	Interpretation	Depth (m)
601	Topsoil	Topsoil layer	0.00-0.15
602	Mid orange brown, clayey sandy silt	Subsoil	0.15-65
603	Yellow brown sand	Natural	0.65-

Trench 7	Dimensions: 26m x 1.6m Depth: 0.65m Trench alignment: NNW-SSE NNW-end Ground Level: 72.60m aOD, SSE-end Ground Level: 72.65m aOD		
Context	Description	Interpretation	Depth (m)
701	Topsoil	Topsoil layer	0.00-0.15
702	Mid orange brown, clayey sandy silt	Subsoil	0.15-65
703	Yellow brown sand	Natural	0.65-

Trench 8	Dimensions: 26m x 1.6m Depth: 0.70m Trench alignment: NNE-SSW NNW-end Ground Level: 72.60m aOD, SSE-end Ground Level: 72.65m aOD		
Context	Description	Interpretation	Depth (m)
801	Topsoil	Topsoil layer	0.00-0.15
802	Mid orange brown, clayey sandy silt	Subsoil	0.15-47
803	Yellow brown sand	Natural	0.47-

Trench 9	Dimensions: 10m x 1.6m Depth: 0.70m Trench alignment: NNW-SSE NNW-end Ground Level: 71.00m aOD, SSE-end Ground Level: 70.65m aOD		
Context	Description	Interpretation	Depth (m)
901	Topsoil	Topsoil layer	0.00-0.15
902	Mid orange brown, clayey sandy silt	Subsoil	0.15-48
903	Yellow brown sand	Natural	0.48-

Trench 10	Dimensions: 16m x 1.6m Depth: 0.67m Trench alignment: NNW-SSE NNW-end Ground Level: 71.60m aOD, SSE-end Ground Level: 71.65m aOD		
Context	Description	Interpretation	Depth (m)
1001	Topsoil	Topsoil layer	0.00-0.15
1002	Mid orange brown, clayey sandy silt	Subsoil	0.15-49
1003	Yellow brown sand	Natural	0.49-

Kent County Council HER Summary Form

Site Name: Land at Newnham Park, Bearsted Road, Maidstone Kent

SWAT Site Code: BEAR/EV/18

Site Address: As above

Summary:

Swale and Thames Survey Company (SWAT) carried out Archaeological Evaluation on the development site above. The site has planning permission for the of car parking whereby Maidstone Borough Council requested that Archaeological works be undertaken to determine the possible impact of the development on any archaeological remains.

The Archaeological Monitoring consisted of an Archaeological Evaluation which revealed no archaeology.

District/Unitary: Maidstone Borough Council

Period(s):

NGR (centre of site to eight figures) 578114 157287

Type of Archaeological work: Archaeological Evaluation

Date of recording: October 2018

Unit undertaking recording: Swale and Thames Survey Company (SWAT. Archaeology)

Geology: Underlying geology is Bedrock Geology of Folkestone Formation- Sandstone

Title and author of accompanying report: Wilkinson P. (2018) Archaeological Evaluation of Land at Newnham Park, Bearsted Road, Maidstone, Kent

Summary of fieldwork results (begin with earliest period first, add NGRs where appropriate)

No archaeology found

Location of archive/finds: SWAT. Archaeology. Graveney Rd, Faversham, Kent. ME13 8UP

Contact at Unit: Paul Wilkinson

Date: 15/10/2018

PLATES



Plate 1. General view of Trench 1 (looking SE)



Plate 2. View of section Trench 1



Plate 3. View of Trench 2



Plate 4. Section of Trench 2



Plate 5. View of Trench 3 (looking SE)



Plate 6. Section of Trench 3



Plate 7. View of Trench 4 (looking SE)



Plate 8. General view of Trench 6 (looking N)



Plate 9. Section of Trench 6



Plate 10. View of Trench 7



Plate 11. Section of Trench 7



Plate 12. View of Trench 8 (looking W)



Plate 13. View of Trench 9



Plate 14. View of Trench 10 (looking E)

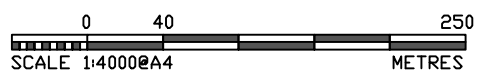
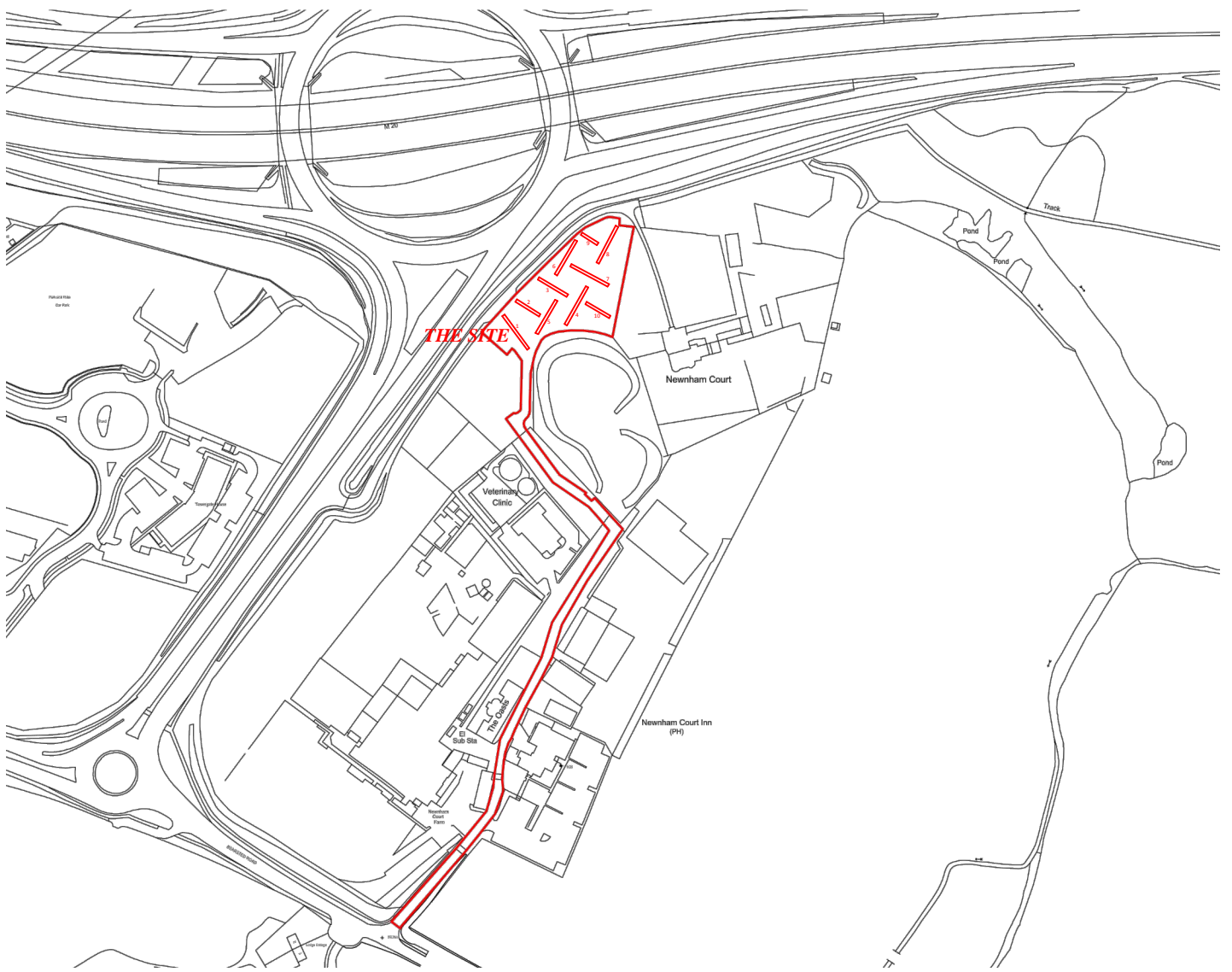

Figure 1: Site Location map



© Crown copyright and database rights 2018. OS 100031961

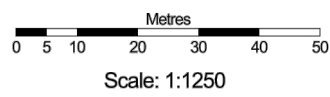

Figure 2: Site plan

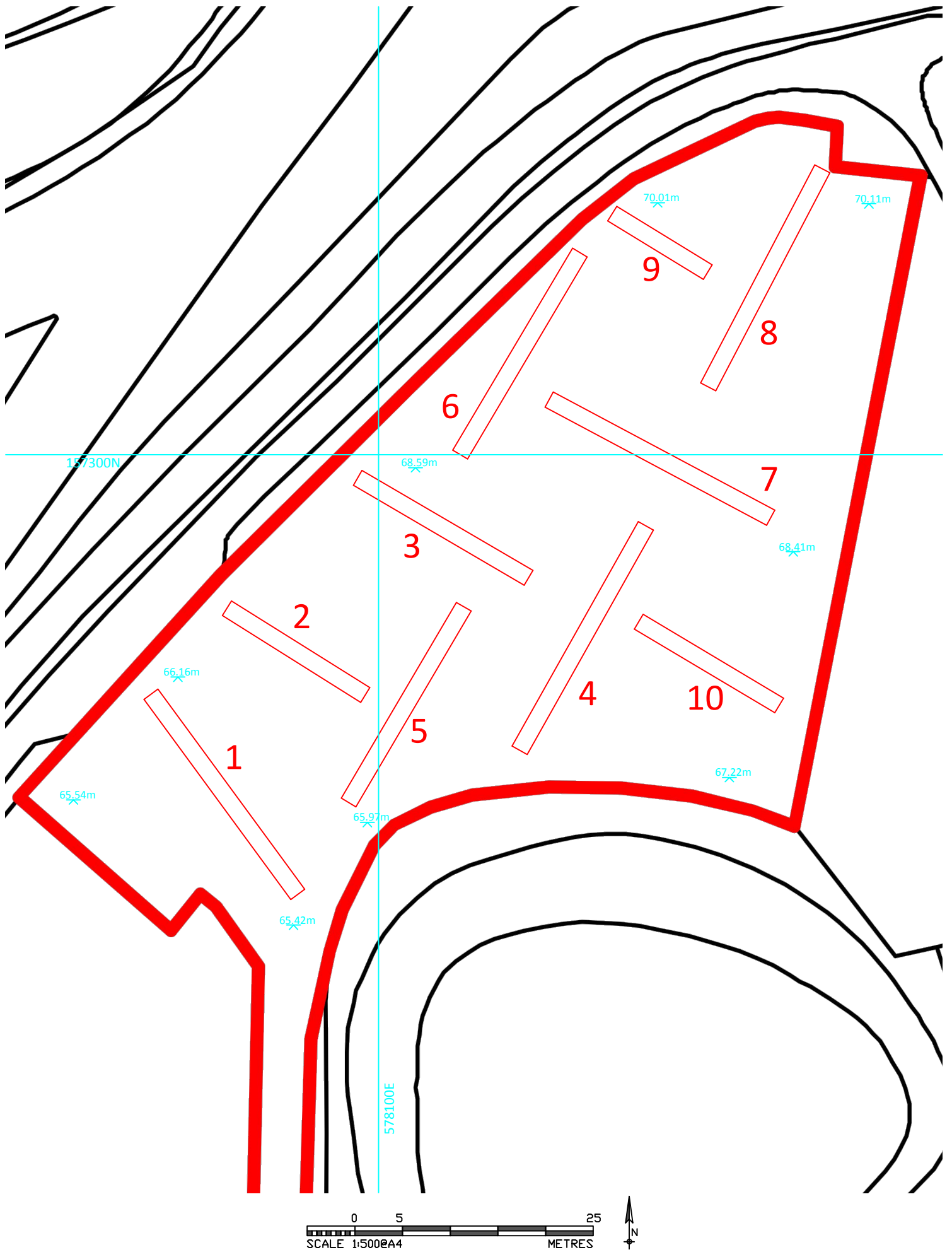

Figure 3: Trench plan